

## Feature

--Intelligent Control: Supports multiple control methods, including APP control (Tuya ecosystem), remote control (2.4G WIFI + Bluetooth), and smart speaker voice control. The light color can be set according to personal preferences, and DIY scene modes are also available. It also comes with additional functions such as music sync and timing.

--Scene Application: Adopts an RGB + CCT dual-color temperature combination, which meets the needs of most scenarios such as office, home, and commercial use. Additionally, the RGB ambient lighting offers vivid colors to create a festive atmosphere.

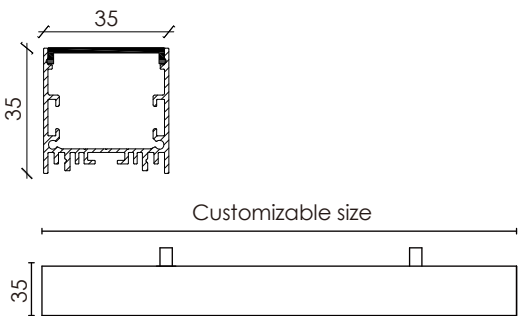

## Luminaire parameters

Size	L1200*W35*H35mm
LM	1100lm(@5000K)
Input Voltage	AC100-240V
Beam Angle	120°
Nominal Power	20W
CCT	RGB+CCT(2700K-6500K)
CRI	>80
Protection Grade	IP40
Certification	CE, ROHS
Warranty	3 years

## Installation Accessories



Suspended Rope



Connector



Aluminum Profile

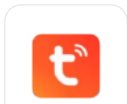

Tuya APP



Remote Control

## Installation

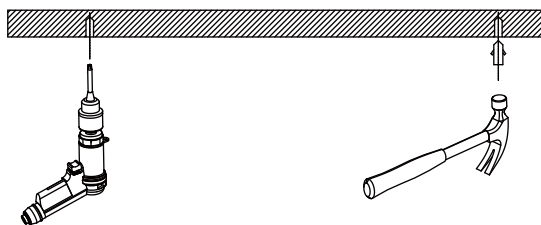

① Prepare the electric drill, hammer, stud;

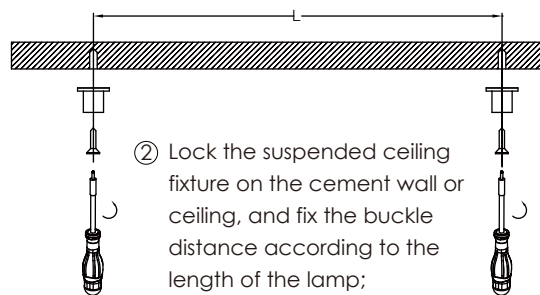

② Lock the suspended ceiling fixture on the cement wall or ceiling, and fix the buckle distance according to the length of the lamp;

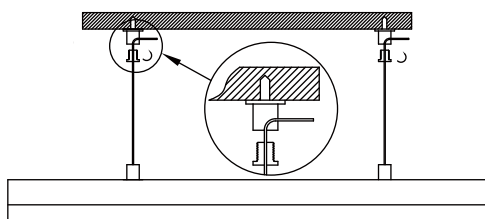

③ Lock the wire sling fixing parts, and fixed the installation length by adjust the wire sling;

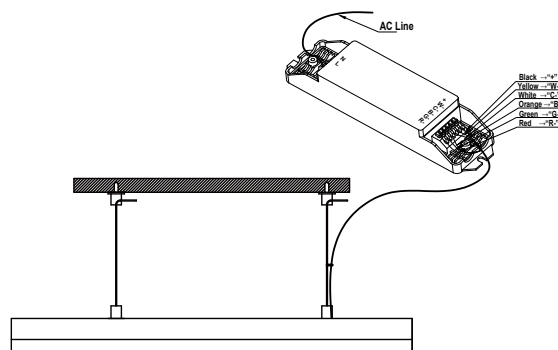

④ Connect the power supply and complete the installation.

## Packing

① Product

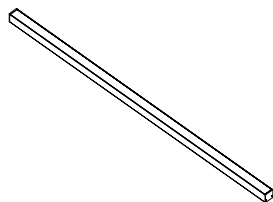

② Packing

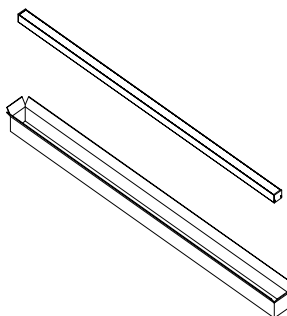

③ Sealing

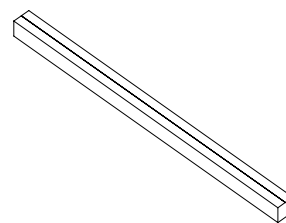

Model HL-CA034-1-L12  
Inner box 1240\*86\*116mm

Carton box 1255\*450\*355mm  
QTY/Carton 15 PCS

## Notices

- 1.The power supply must be turned off before installation.
- 2.Make sure the product is mounted under the surface of the object to be installed, and finally turn on the power to light up.
- 3.This product is for indoor use only.
- 4.This product is warranted for 3 years and problems occur within 3 years (except for human factors and accidental factors), free maintenance.
- 5.The product is not responsible for damage caused by accidental factors or improper use.