

 Updated Version 2.0

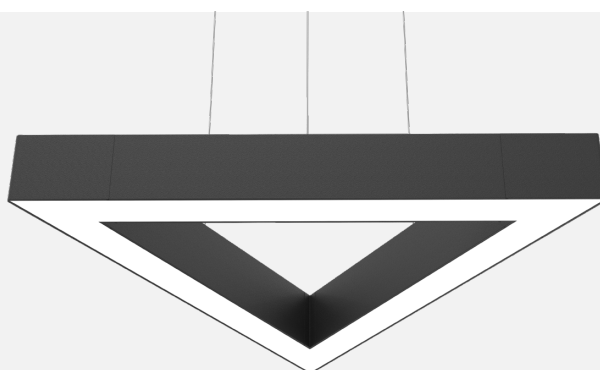

Frosted texture

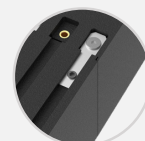

Accurate splicing

Feature

- Modular triangular linear lighting offer infinite possibilities.
- The module joints are precisely designed, with a smooth surface and no protrusions, and smooth overall lines.
- The shell is made of anodized matte aluminum alloy, which has a delicate touch and is anti-fingerprint. Meanwhile, the matte surface softens the light to avoid glare.
- The power supply is built-in and the wiring is of the PUSH-IN shrapnel type. It is easy to install, disassemble, and maintain.
- Frosted metal texture and smooth minimalist lines are suitable for high-end commercial scenes, minimalist home spaces, public cultural places, etc.



Modular



DIY Splicing



Customizability



Easy Maintenance



Scalability



Flexibility



Shrapnel-type Wiring

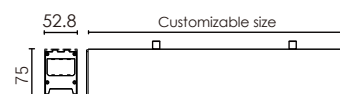
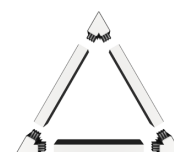

Luminaire parameters

Model	HL-PB5075A-A06
Size	600*600*600mm
Nominal Power	40W
Lm	6000lm±10%(@4000K)
Beam Angle	110°-120°
Input Voltage	AC100-277V
CCT	2700-6500K
CRI	>80
Protection Grade	IP20
Certification	CE, ROHS,UL
Warranty	3 years

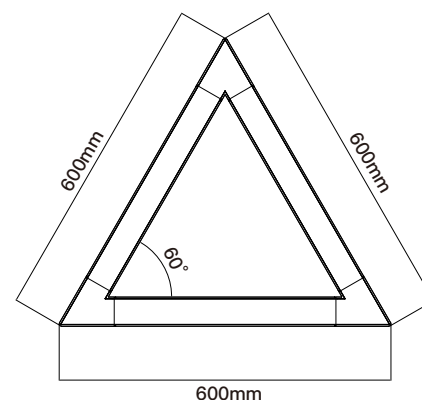

Installation Accessories

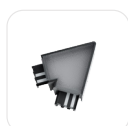

module1



module2

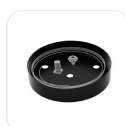

Accessory

Installation

Step 1: Assembly product

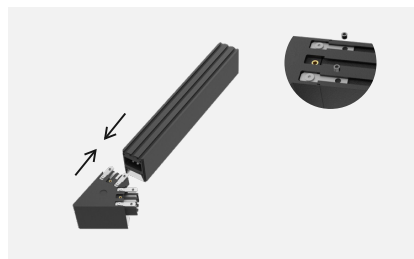

①



②



③



④



⑤

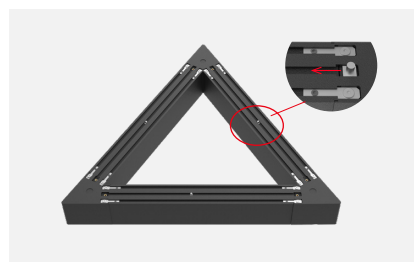

⑥

Step 2: Install

Please make sure that the place of installation could stand 10 times the weight of itself before installing in a place where is no vibration, no swing, and no fire risk.

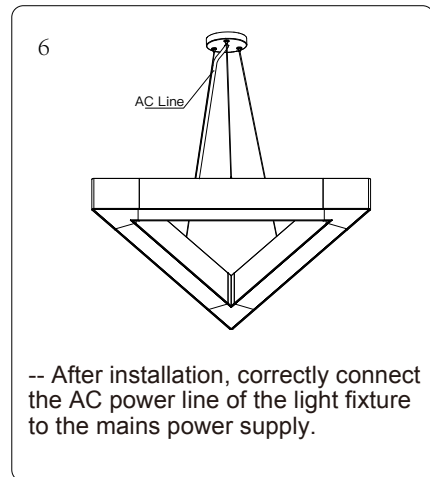
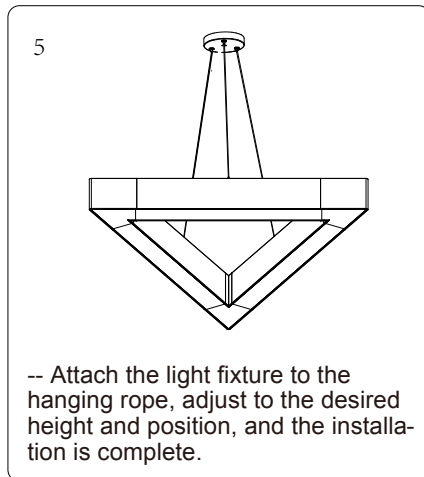
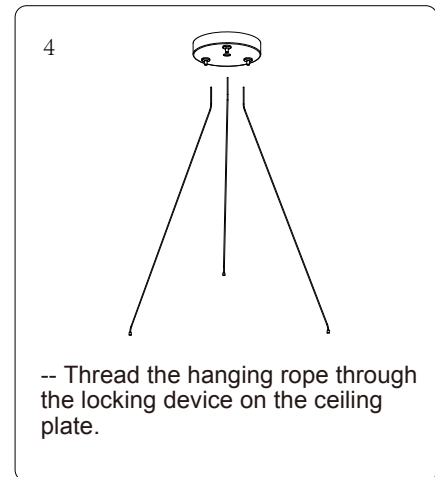
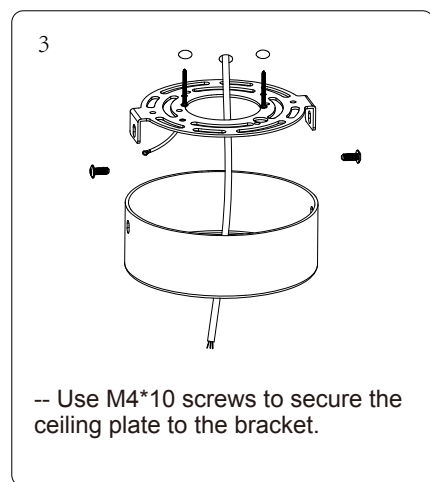
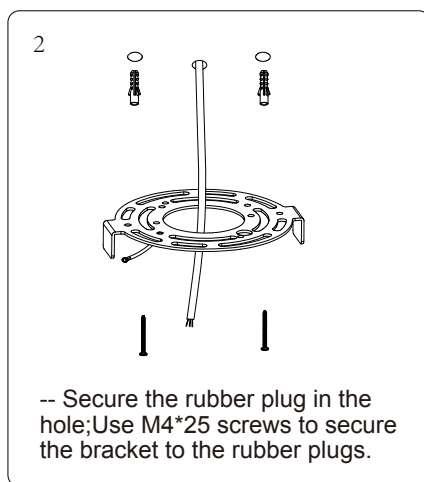
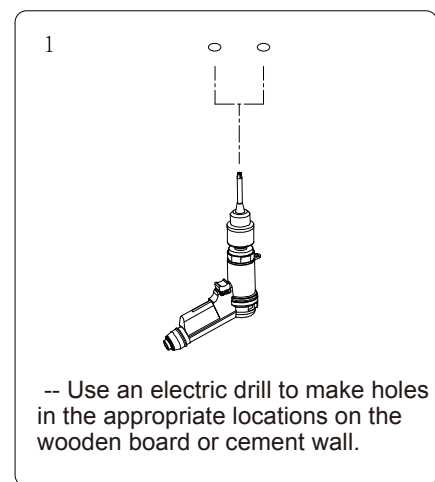

Packing

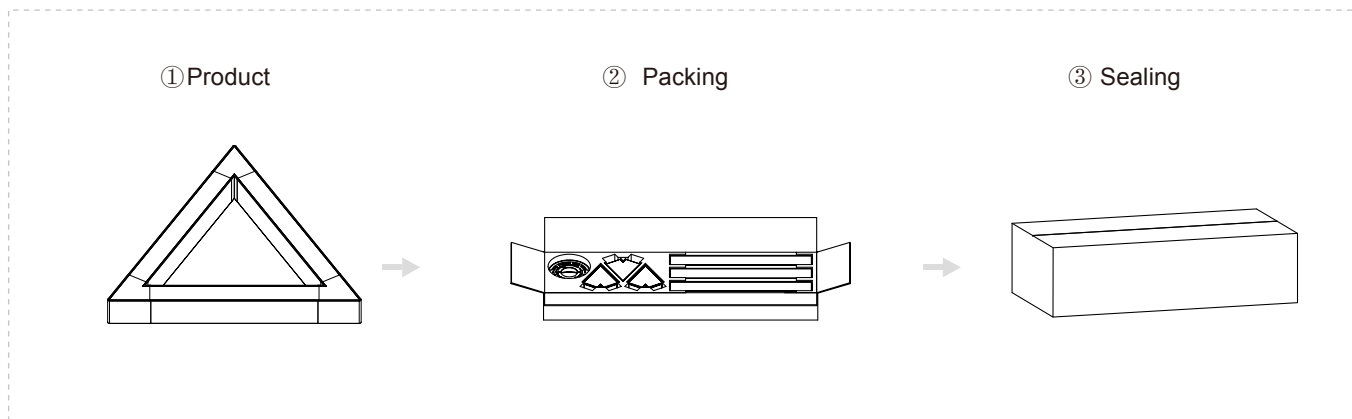

Model	HL-PB5075A-A06	Carton box	813*432*224mm
Inner box	800*210*100mm	QTY/Carton	4 PCS
NW	3.8kg/PCS	GW	4.5kg/PCS

USER INSTRUCTIONS

- 1.The installation of the unit must be done by a qualified electrician.
- 2.The unit must be earthed in case an earth connecting point exists.
- 3.Ensure that the mains is switched off during servicing.
- 4.Ensure that after the installation,the unit is properly fixed and the cable clamps (if exist)are well tightened.
- 5.Manufacturer will not accept liability for injury or damage resulting from incorrect use or installation.