

UGR<19

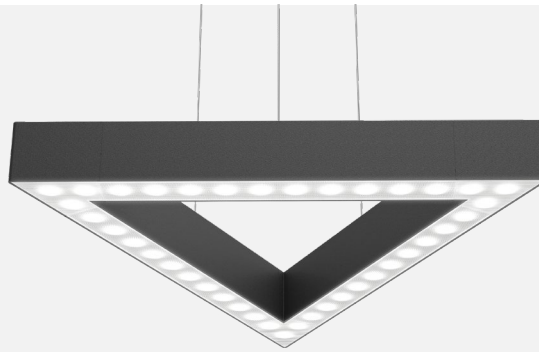

Frosted texture

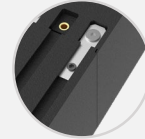

Accurate splicing

## Feature

- Modular triangular linear lighting offer infinite possibilities.
- It adopts lens + anti-glare reflector cup + prism anti-glare cover design, and the light output is uniform without dark areas.
- Deep anti-glare, UGR<19, the light is comfortable, soft and not dazzling.
- The power supply is built-in and the wiring is of the PUSH-IN shrapnel type. It is easy to install, disassemble, and maintain.
- Minimalist appearance, streamlined design, no height difference, and matte texture craftsmanship make the product high-end, durable and practical.



Modular



DIY Splicing



Customizability



Easy Maintenance



Scalability



Flexibility



Shrapnel-type Wiring

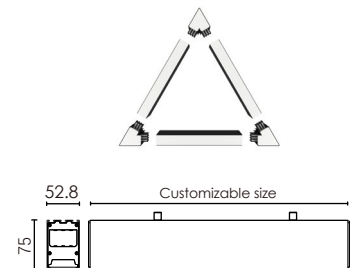

## Luminaire parameters

Model	HL-PB5075A-A06-N
Size	600*600*600mm
Nominal Power	40W
Lm	2800lm±10%(@4000K)
Beam Angle	65°
Input Voltage	AC200-240V
CCT	2700-6500K
CRI	>80
Protection Grade	IP20
Certification	CE, ROHS
UGR	<19
Warranty	3 years

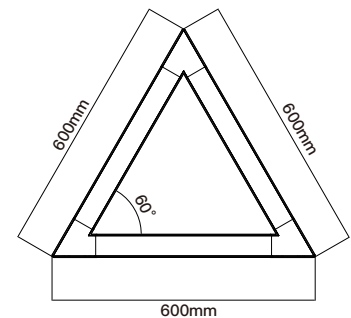

## Installation Accessories



module1



module2

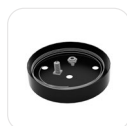

Accessory

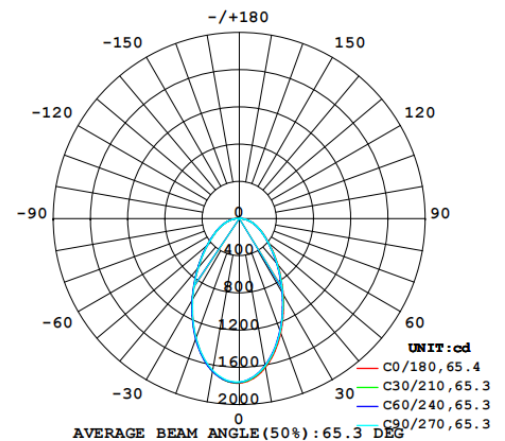

## Installation

### Step 1: Assembly product



①



②



③



④



⑤

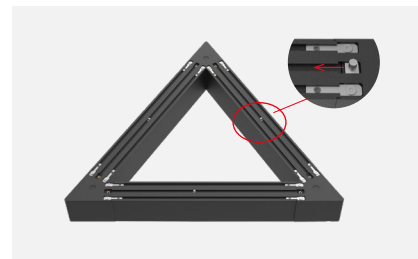

⑥

### Step 2: Install

Please make sure that the place of installation could stand 10 times the weight of itself before installing in a place where is no vibration, no swing, and no fire risk.

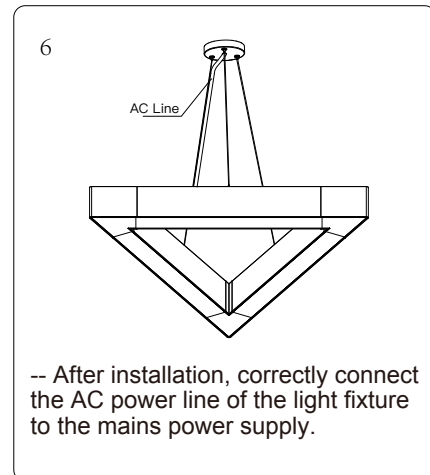
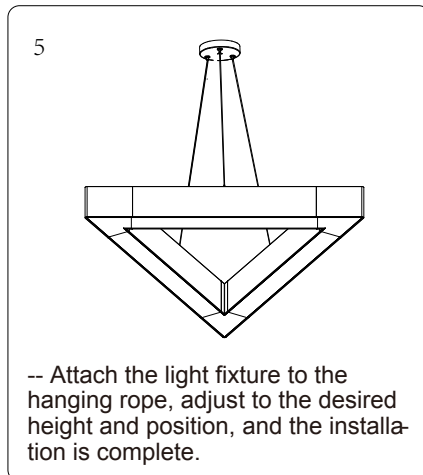
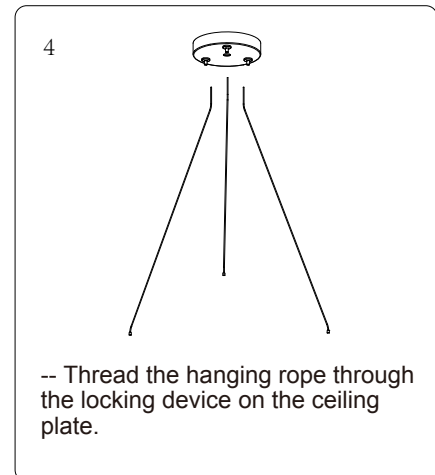
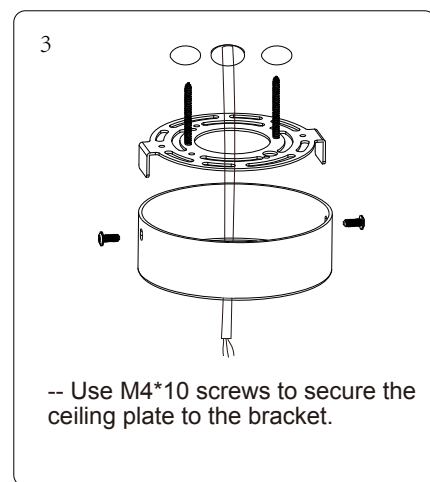
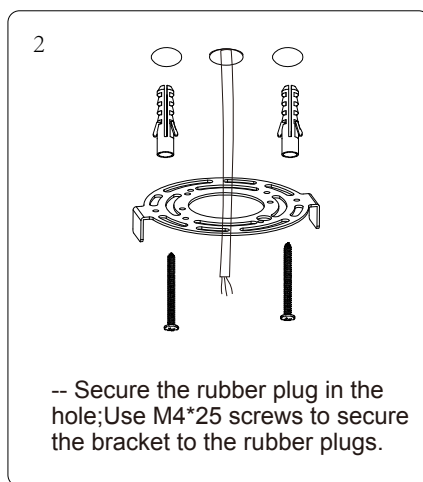
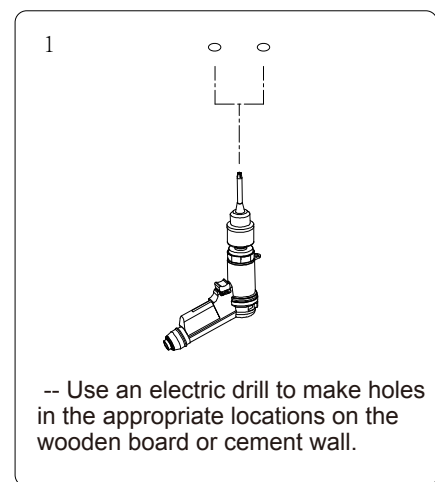

## Packing

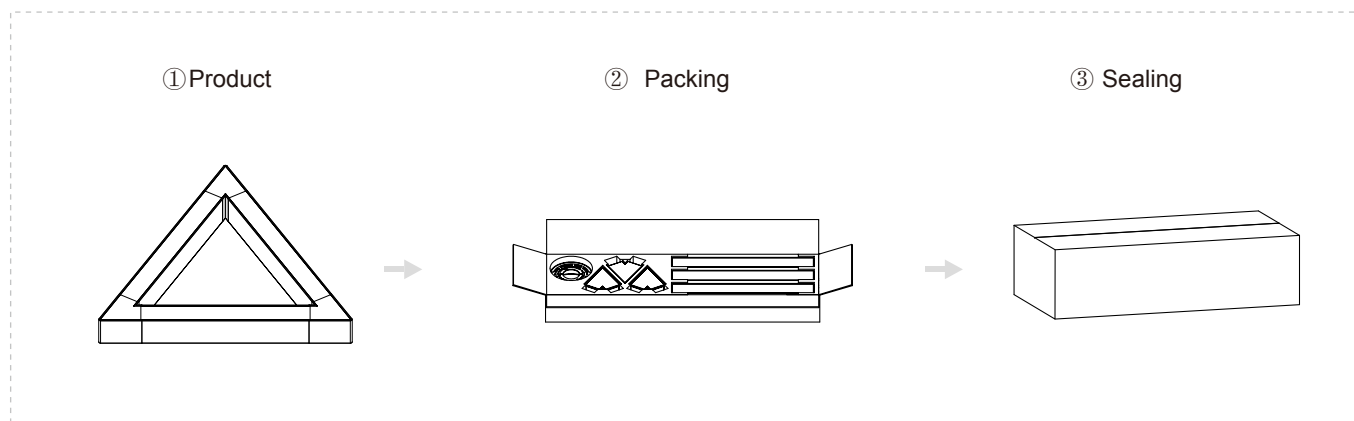

Model	HL-PB5075A-A06-N	Carton box	813*432*224mm
Inner box	800*210*100mm	QTY/Carton	4 PCS
NW	3.9kg/PCS	GW	4.6kg/PCS

## USER INSTRUCTIONS

- 1.The installation of the unit must be done by a qualified electrician.
- 2.The unit must be earthed in case an earth connecting point exists.
- 3.Ensure that the mains is switched off during servicing.
- 4.Do not use bulb(s) bigger than the indicated on units name-plate or packaging.
- 5.Ensure that after the installation,the unit is properly fixed and the cable clamps (if exist)are well tighened.
- 6.Manufacturer will not accept liability for injury or damage resulting from incorrect use or installation.