

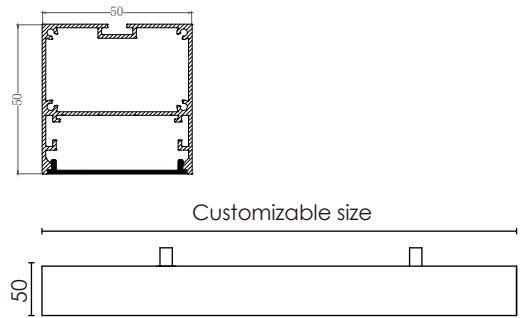

Feature

- Professional appearance design, simple and elegant.
- High quality, energy-efficient LED Lighting for environmental protection.
- Anodized aluminum profile with good heat sink.
- External power supply, no flicker.
- For offices, conference rooms, supermarkets, home lighting, etc.



Luminaire parameters

| | |
|------------------|-----------------|
| Size | L1200*W50*H50mm |
| Lm | 7500lm |
| Input Voltage | AC100-240V |
| Beam Angle | 120° |
| Nominal Power | 50W |
| CCT | 2700-6500k |
| CRI | >80 |
| Protection Grade | IP40 |
| Certification | CE, ROHS |
| Warranty | 3 years |

Installation Accessories



Suspended Rope



Connector



Aluminum Profile

Installation

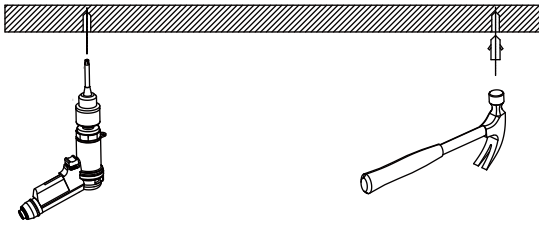

① Prepare the electric drill, hammer, stud;

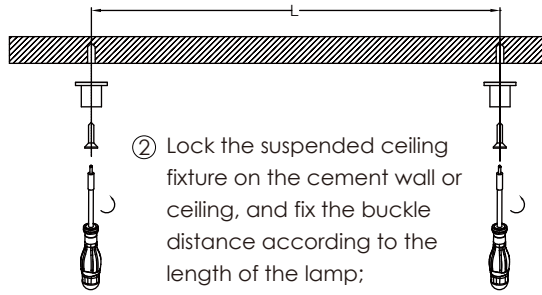

② Lock the suspended ceiling fixture on the cement wall or ceiling, and fix the buckle distance according to the length of the lamp;

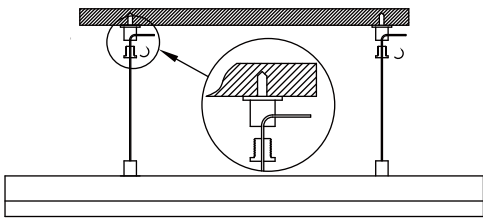

③ Lock the wire sling fixing parts, and fixed the installation length by adjust the wire sling;

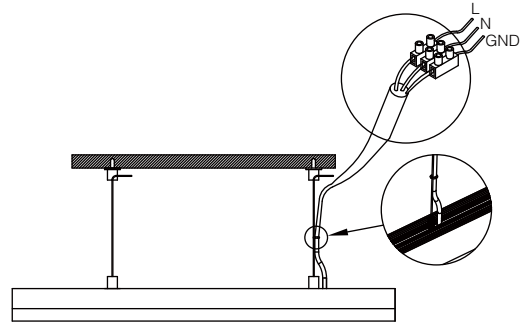

④ Connect the power supply and complete the installation.

Packing

① Product

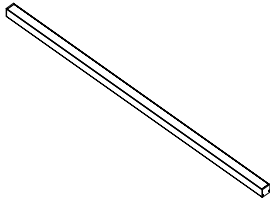

② Packing

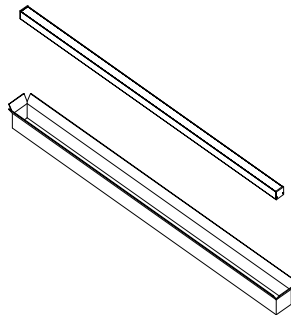

③ Sealing

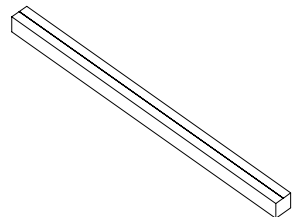

| | | | |
|-----------|-----------------|------------|-------------------|
| Model | HL-CB5050-L12 | Carton box | L1240*W350*H350mm |
| Inner box | L1230*W85*H85mm | QTY/Carton | 8 PCS |

Notices

- 1.The power supply must be turned off before installation.
- 2.Make sure the product is mounted under the surface of the object to be installed, and finally turn on the power to light up.
- 3.This product is for indoor use only.
- 4.This product is warranted for 3 years and problems occur within 3 years (except for human factors and accidental factors), free maintenance.
- 5.The product is not responsible for damage caused by accidental factors or improper use.