

# SILICONE NEON STRIP

HL-N0817V24-Cxx

Side view





### Model: HL-N0817V24-Cxx

- High light transmittance, environmental protection grade silicone material, integrated extrusion molding process.
- Unique optical light distribution structure design, uniform lighting surface and no shadow.
- IP67 protection level, salt solution resistance, acids & alkalis, corrosive gases, fire and UV
- Excellent toughness, simple and stylish appearance, delicate and unique
- 5 years warranty.

### Dimension structure

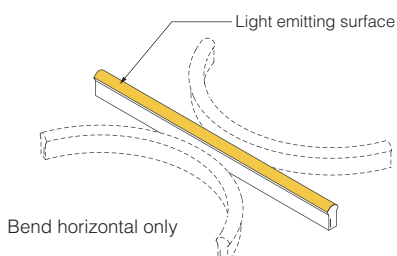
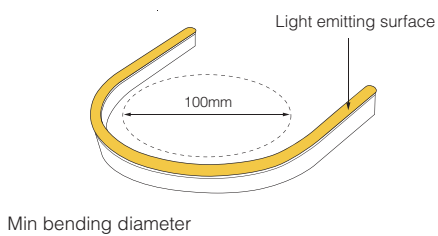
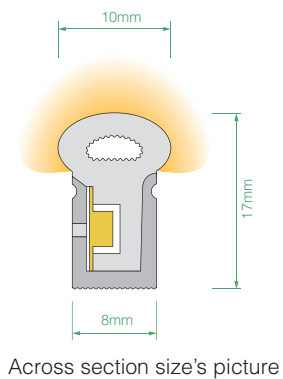
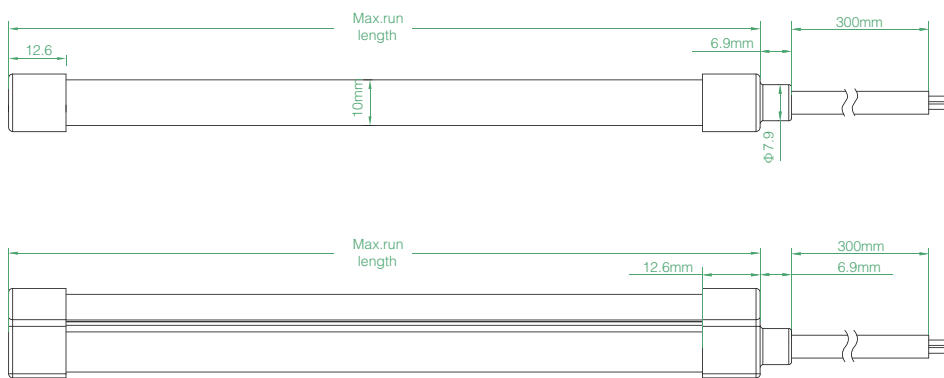

### Electrical Parameter

Voltage	DC24V
LED PIN temperature	Max. 65°C
Storage Temperature	-25°C ~ 60°C
Ambient temperature	Min.-25°C, Max ( Table below )
CRI	>90

### Specification

Power	5w/m	10w/m
Efficacy(lm/w)@4000K	34.8lm/w	34lm/w
Max ambient temperature	50°C	45°C

Due to the tolerance of the production and electrical components, output value and electrical power can vary up to 10%

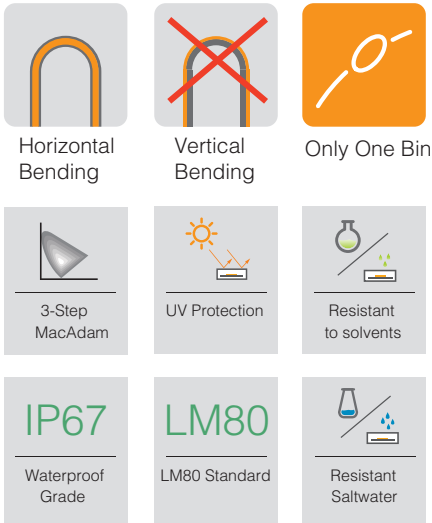

Finished CCT (K)	Unit cut (mm)	CR I	Power (W)	Lumen (LM/m)	Efficacy (LM/w)	Max.run length(m)	CV/CC
● 2100 ±100	50	>90	5 10	142 271	28.4 27.1	19 13	CC/CV
● 2400 ±100	50	>90	5 10	148 285	29.6 28.5	19 13	CC/CV
● 2700 ±100	50	>90	5 10	159 310	31.8 31.0	19 13	CC/CV
● 3000 ±100	50	>90	5 10	160 311	32.0 31.1	19 13	CC/CV
● 3500 <sup>+200</sup> / <sub>-100</sub>	50	>90	5 10	167 323	33.4 32.3	19 13	CC/CV
● 4000 <sup>+300</sup> / <sub>-200</sub>	50	>90	5 10	174 340	34.8 34.0	19 13	CC/CV
● 5000 <sup>+300</sup> / <sub>-200</sub>	50	>90	5 10	175 344	35.0 34.4	19 13	CC/CV
● 6000 <sup>+300</sup> / <sub>-100</sub>	50	>90	5 10	166 319	33.2 31.9	19 13	CC/CV
● TW	50	>90	● 2.5 ● 2.5 ● 5	81 83 161	32.4 33.2 32.2	5 5 5	CV
● TW	50	>90	● 5 ● 5 ● 10	169 173 332	33.8 34.6 33.2	5 5 5	CV
● R	50	--	5 10	70 150	14.0 15.0	25 17	CC/CV
● G	50	--	5 10	190 356	38.0 35.6	19 13	CC/CV
● B	50	--	5 10	38 71	7.6 7.1	19 13	CC/CV
● Amber	50	--	5 10	59 116	11.8 11.6	25 17	CC/CV
● Pink	50	--	5 10	74 148	14.8 14.8	19 13	CC/CV

- TW: Tunable white, Testing CCT: 2700K+5400K
- Max series length refers to single side feed
- The above color temperature is the finished-product color temperature.
- The given data are typical values due to the tolerance of the production and electrical components, output value and electrical power can vary up to 10%
- Please don't walk on it without protection.

Power (W)	Finished CCT (K)	Lumen (LM/m)	Efficacy (LM/w)	Unit cut (mm)	Max.run length(m)	CV/CC
5	●●● R	17	10.2	62.5	5	CV
	●●● G	56	33.6			
	●●● B	11	6.6			
	●●● RGB	82	16.4			
10	●●● R	36	10.8	62.5	5	CV
	●●● G	94	28.2			
	●●● B	17	5.1			
	●●● RGB	144	14.4			

### Cutting Method & Seal the section



It is feasible to cut along the black point on the side of led strip. Do not cut optionally to avoid damage to led strip

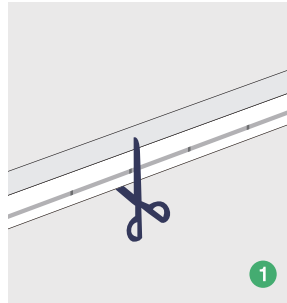

Cut the appropriate place

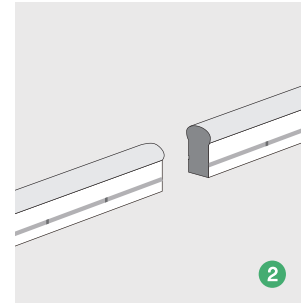

Finished the cutting

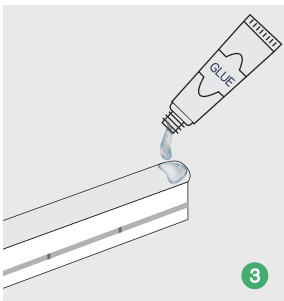

coat the section with glue uniformly after cutting

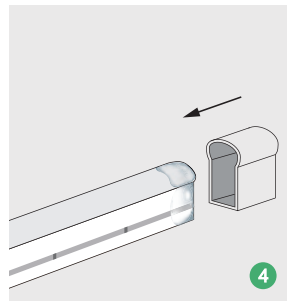

Insert the section into the plug according to direction of arrow



Dry the plug with hot wind or natural wind until make sure the installation is firm

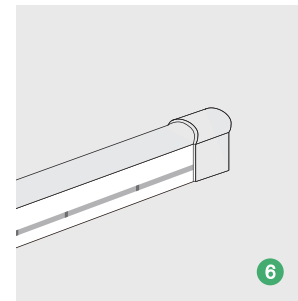

The effect of finished plug installation

### Mounting Way



Aluminium Mounting clips  
20x10.6x14mm(L x W x H)



Aluminium Profile  
1000x10.6x14mm(L x W x H)



Flexible profile  
1000x11x10.3mm(L x W x H)

Wiring diagram

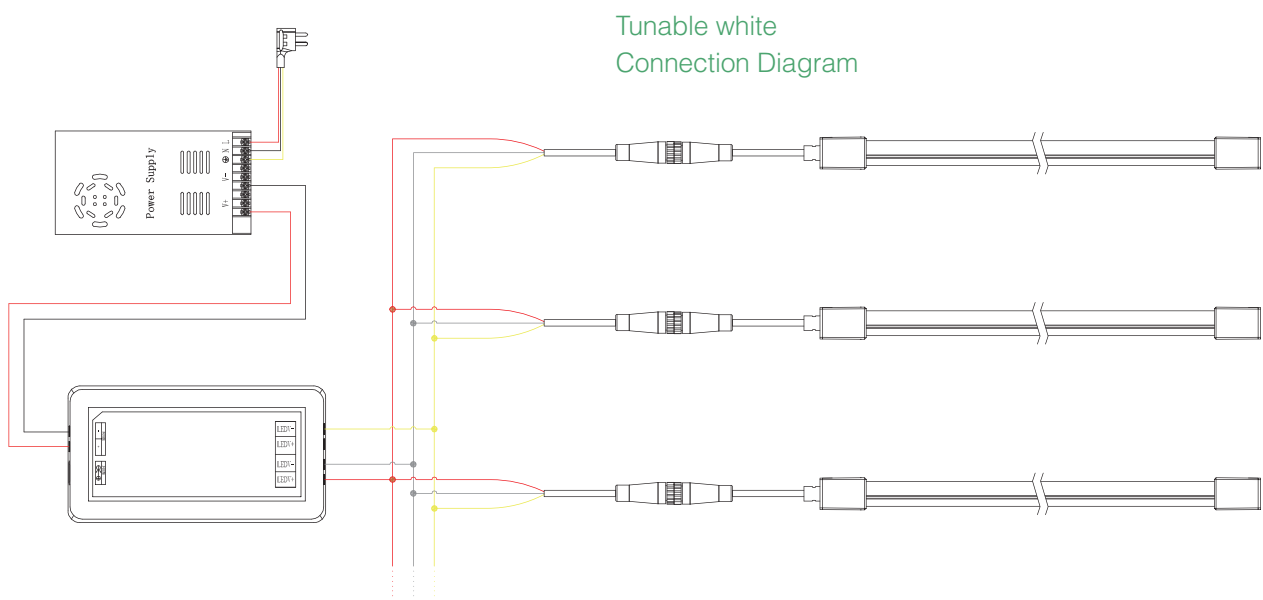
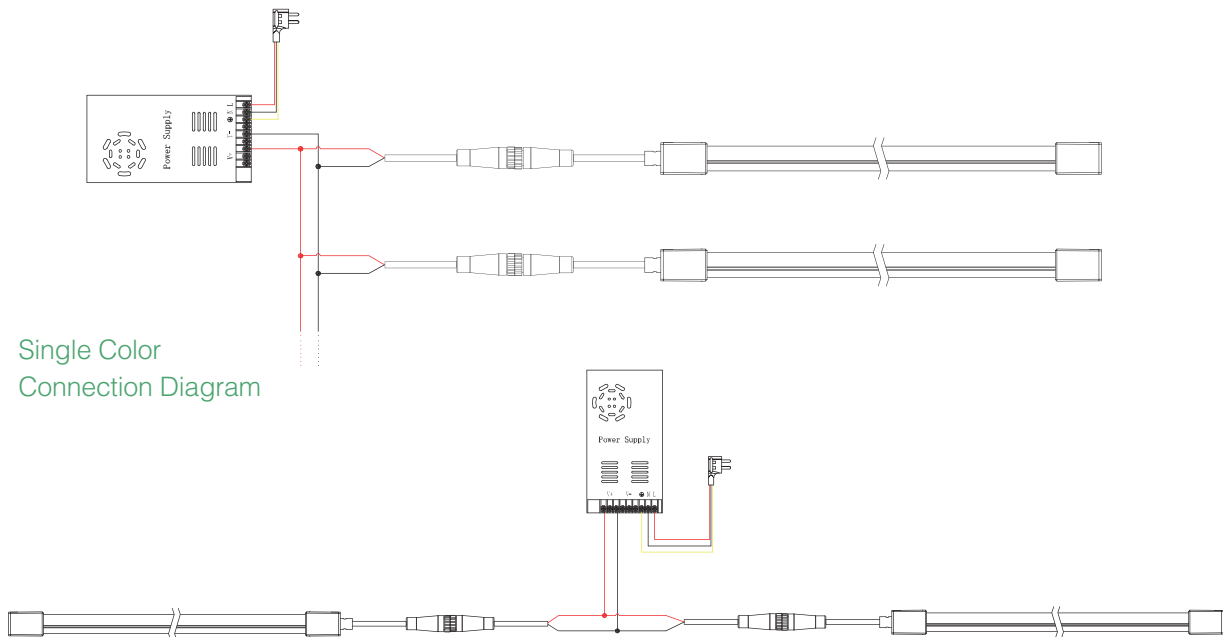

Wiring diagram

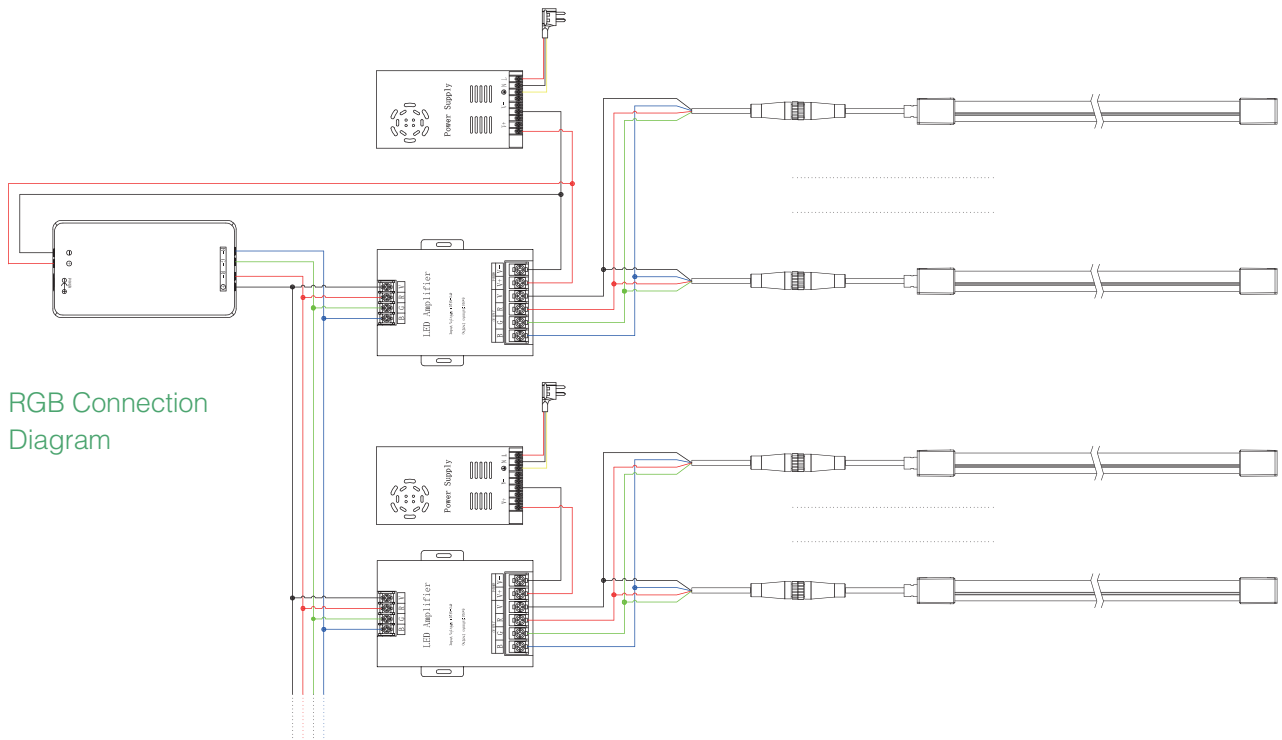

RGB Connection Diagram

HELIAN

**Specialized  
LED strip  
Manufacturer**

## Shenzhen Helian Electronics Co.,Ltd



3F, Tonggao building 2, Sanlian industrial area, Songbai Rd, Shiyan Town, Bao'an District, Shenzhen, Guangdong, China



**OUR EMAIL**

admin@hlled.com



**OUR PHONE**

(86)-755-27606785



**OUR WEBSITE**

www.hlled.com