

Feature

- The hexagonal honeycomb shape is beautiful and stylish, and it is also very stable;
- The lamp body is made of iron art high-temperature baking paint technology, which is fine and delicate, anticorrosive and antirust, stable in its color, durable and strong;
- Lens light source, balanced illumination, clear and bright, long-lasting and high-brightness, and non-irritating;
- Constant current LED drive power, no flicker, high stability, low energy consumption, more power saving;
- Various application scenarios including department stores, supermarkets, indoor offices, fitness places, Internet cafes, corridors and aisles.

Luminaire parameters

Model	HL-H9870-L06	HL-H9856-L12
Size	L600*W520*H70mm	L1200*W1039*H56mm
Nominal Power	60W	90W
Lm	3000lm	4300lm
Beam Angle	110°	
Input Voltage	AC200-240V	
CCT	2700-6500k	
CRI	>80	
Protection Grade	IP40	
Certification	CE, ROHS	
Warranty	3 years	

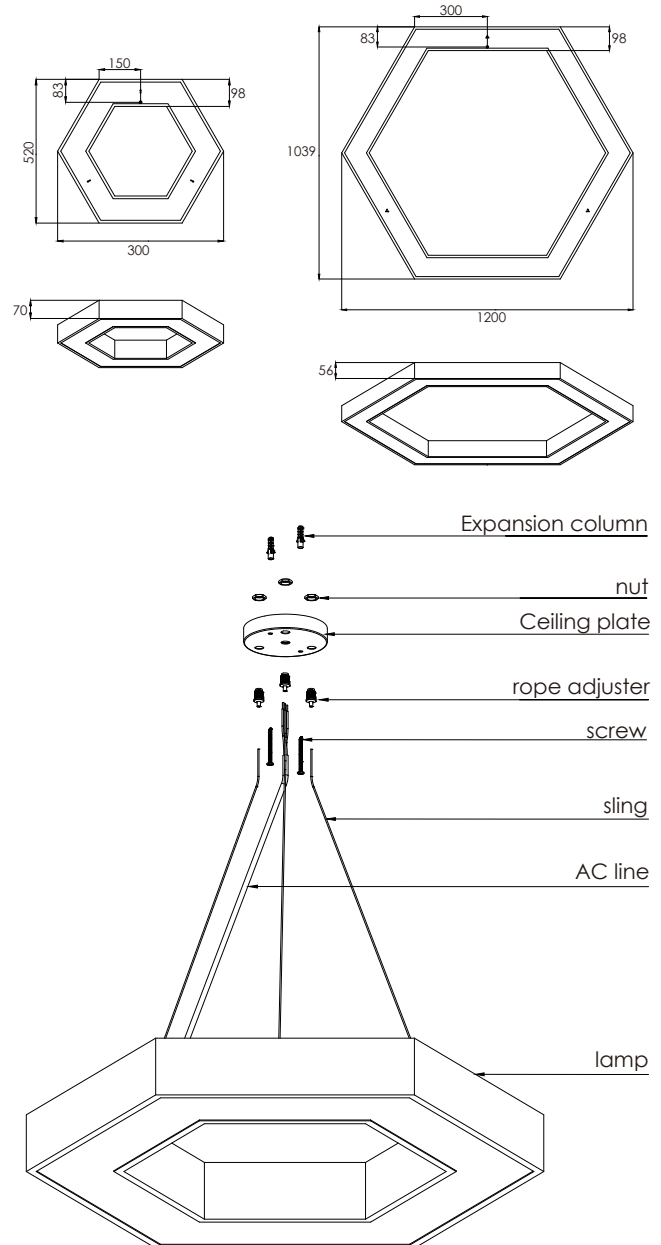

Installation



Step 1: Use an electric drill tool to drill holes in the appropriate position on the wooden board or cement wall



Step 2: Fix the rubber plug on the hole in the wood or cement wall

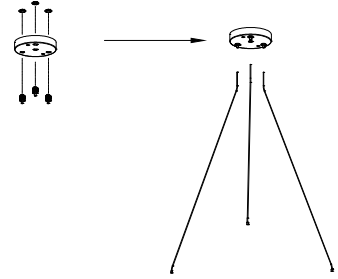

Step 3: After installing the suspension wire adjuster into the suspension wire adjuster, use nuts to secure it to the ceiling plate

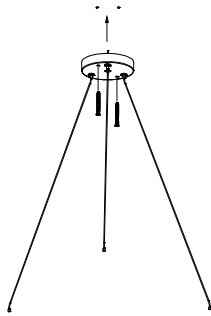

Step 4: Use screws to fix the ceiling cup on the wood or concrete wall

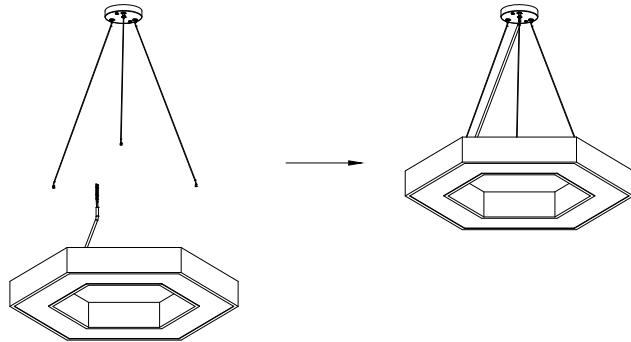

Step 5: After the lamp is installed on the sling, the installation is complete

Packing

① Products

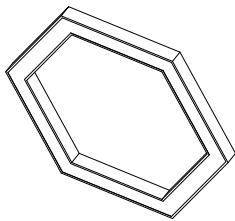

② Packing

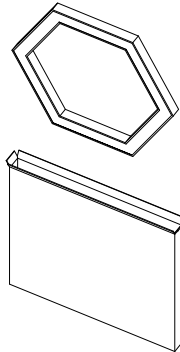

③ Sealing

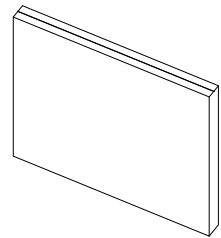

Model	Carton box	QTY/Carton
HL-H9870-L06	L610*W100*H535MM	1 PCS
HL-H9856-L12	L1220*W80*H1070MM	1 PCS

Notices

- 1.The power supply must be turned off before installation.
- 2.Make sure the product is mounted under the surface of the object to be installed, and finally turn on the power to light up.
- 3.This product is for indoor use only.
- 4.This product is warranted for 3 years and problems occur within 3 years (except for human factors and accidental factors), free maintenance.
- 5.The product is not responsible for damage caused by accidental factors or improper use.