

Feature

- The lamp surface adopts suction installation design, with small, exquisite design and beautiful appearance, and plug-in AC power cord for more convenient use;
- The main body of the lamp is made of 6063-T5 aluminum, with good heat dissipation performance, long service life, and more environmentally friendly;
- Adopting SMD LED light source, with long service life, strong anti-light decay and stable point;
- Adopting built-in constant voltage power supply, safe and reliable, without flicker;
- PMMA material cover, with high light transmittance, strong weather resistance, high temperature resistance, corrosion resistance, strong impact resistance, and anti-aging;
- Application: bathrooms, toilets, dressing rooms, etc.

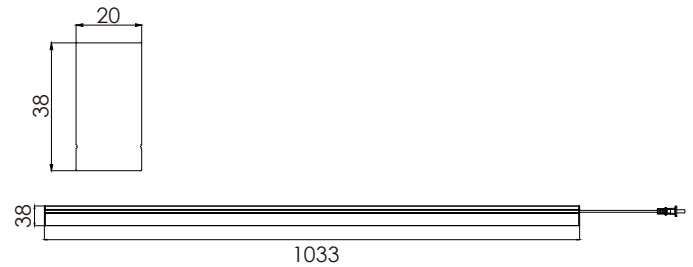

Luminaire parameters

Size	L1033*W20*H38mm
Lm	960lm
Input Voltage	AC100-240V
Beam Angle	220°
Nominal Power	8W
CCT	2700-6500k
CRI	>80
Protection Grade	IP40
Certification	CE, ROHS
Warranty	3 years

Installation Accessories



Aluminum Profile



End Cap



Clip

Installation

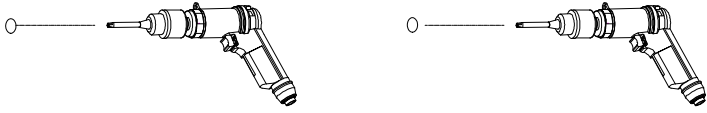

Step 1: Use an electric drill tool to drill holes in a suitable location on a wooden board or cement wall.



Step 2: Fix the plastic clip with screws to the hole position on the wooden board or cement wall.



Step 3: Install and fix the lamp on the plastic clip, and finally plug in the power cord to turn on the light.

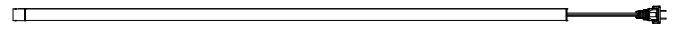

Packing

① Products

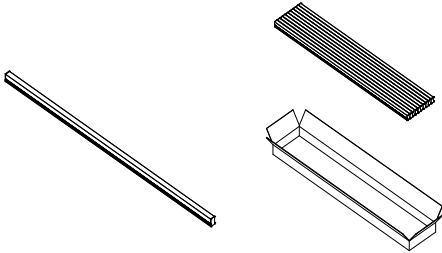

② Packing

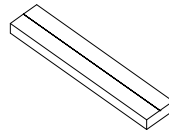

③ Sealing

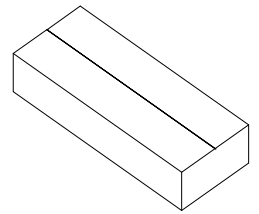

Model	HL-J033-L12
Inner box	1060*205*75mm/10PCS

Carton box	1080*430*245mm/10PCS
QTY/Carton	60 PCS

Notices

- 1.The power supply must be turned off before installation.
- 2.Make sure the product is mounted under the surface of the object to be installed, and finally turn on the power to light up.
- 3.This product is for indoor use only.
- 4.This product is warranted for 3 years and problems occur within 3 years (except for human factors and accidental factors), free maintenance.
- 5.The product is not responsible for damage caused by accidental factors or improper use.