

HL-YA036-L06/ HL-YA036-L12

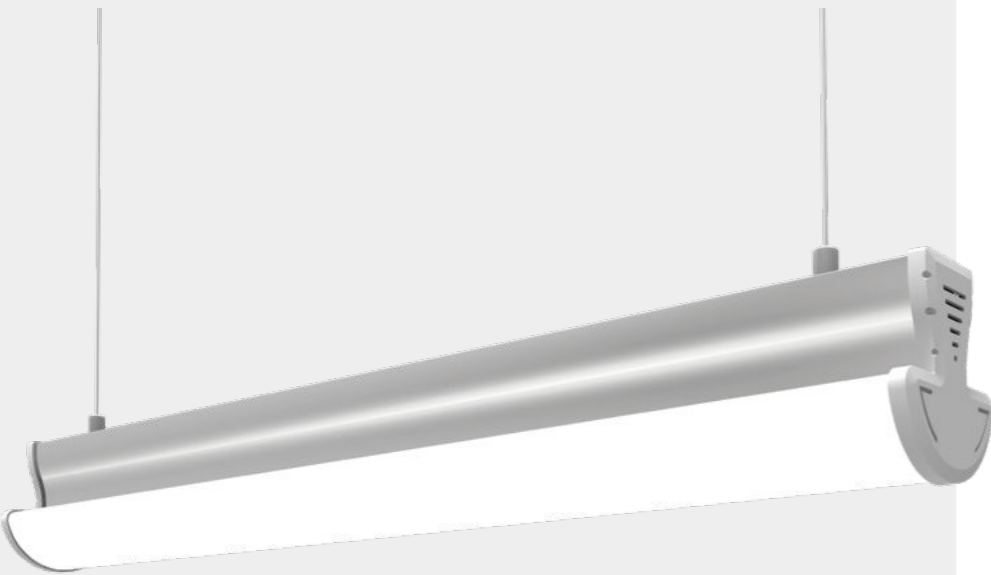

- Inspiration design comes from Mushroom.
- Maintain professional appearance industrial appearance with design patent.
- luminous efficacy up to 120 lm/w.
- High quality, energy-efficient LED Lighting for environmental protection.
- Anodized aluminum profile with good heat sink.
- For offices, conference rooms, super markets, home lighting, etc.

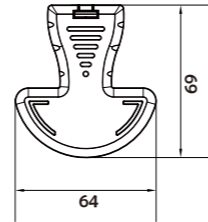

FIXTURE PARAMETERS

Dimension: L600*W64*H69mm/L1200*W64*H69mm

Luminous Flux: 2600lm/5300lm

Input Voltage: AC100-240V

Beam Angle: 130°

Nominal Power: 20W/40W

CCT: 2700-6500k

CRI: >80

Protection Grade: IP20

Certification: CE, ROHS

Warranty: 3 years

Color: ■ ■



Suspended Rope

Optional Connector

Splicing Method

Aluminum Profile

