

HL-TA083-L12

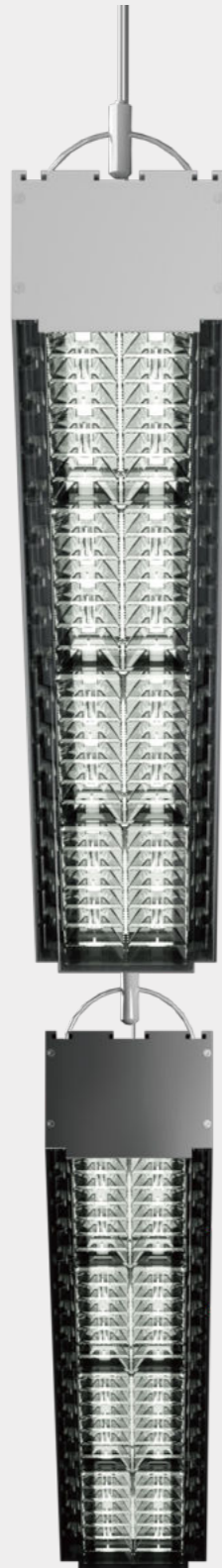

- Professional appearance design, simple and elegant.
- LED 2835-0.5W single chip, low power consumption, long life, good heat dissipation, energy saving and environmental protection.
- Built-in power supply, no flicker.
- The whole lamp can be used for transverse splicing and longitudinal splicing.
- Professional square cone reflector with reflective glass Angle 60° * 70°, stylish appearance, exquisite and unique.
- Application: offices, conference rooms, supermarkets, schools, home lighting and so on.

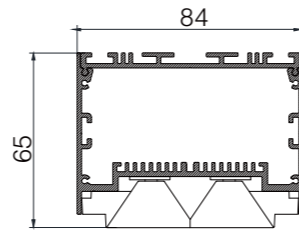

FIXTURE PARAMETERS

Dimension: L1200*W84*H65mm

Luminous Flux: 7600lm

Emergency: Regular / emergency (15w)

Input Voltage: AC100-240V

Beam Angle: 60° * 70°

Nominal Power: 65W

CCT: 2700-6500k

CRI: >80

Protection Grade: IP40

Certification: CE, ROHS

Warranty: 3 years

Color: ■ ■

